

# SPA-400

product specifications  
Commercial grade drinking water system  
for the home spa and bath

The same commercial quality that makes Everpure® the overwhelming choice for water filtration in restaurants is now available for your entire home, including the home spa and bathroom. Everpure's SPA-400 addresses the issues associated with water quality in the bathroom by reducing unwanted lead, particulate and chemical impurities and retaining healthful minerals such as flouride, making it the perfect water source for teeth brushing and a healthy mouth. The SPA-400 is designed to connect to your existing lavatory faucet, so bringing the convenience of filtered water to your master bath, children's or guest bathroom is easier than ever.



The Everpure SPA-400 Drinking Water System for the home spa and bath reduces the following contaminants:

- > Lead
- > Cysts such as Giardia lamblia, Entamoeba histolytica and Cryptosporidium parvum

And the following substances:

- > Chlorine taste and odor
- > Dirt and cloudiness\*
- > Mold and algae\*
- > Oxidized iron\*
- > Oxidized manganese\*
- > Oxidized sulfides\*
- > Particles 1/2 micron and larger in size

The SPA-400 delivers water at a 2.2 gal/min flow, and brings the convenience of filtered water to your home spa, master bath, children's or guest bathroom.

## It's water filtration you can trust

### the pure solution

Our products polish water to premium quality so that water is sparkling and free of unwanted tastes and odors. You'll taste the difference in every sip you drink and everytime you brush your teeth.

### the sensible solution

Our filters reduce lead amounts in your water — below the Federal Action Level of 10 ppb — as well as parasitic protozoan cysts and other microscopic particles that may be in your water supply.

### the convenient solution

The SPA-400 is easily installed using common household tools. This system mounts under your sink and is plumbed to your standard lavatory faucet. And cartridge replacement is easy, too — just like changing a light bulb.

### the practical solution

At only pennies per gallon, this system is less expensive per glass than bottled water or other drinking water systems and provides about a year's supply of water, depending on the size of your family and the amount of water you use.

\*As tested by Everpure, LLC

AquaHealth Systems, Inc.  
2300 South Clinton Ave. Unit F  
South Plainfield, NJ 07080  
Ph: 1-800-225-PURE (7873) Fax: 1-800-647-PURE (7873)  
www.AquaHealthSystems.com

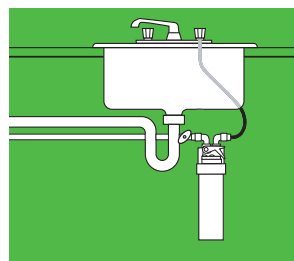

Connects directly to your standard lavatory faucet's cold water line.



Built-in water shut off.

Our systems leave vital minerals found naturally in water, so you get the best tasting water possible.

Everpure's signature metal canister delivers commercial grade durability and quality and protects the filter system from splitting or bursting. It's lined with a food-grade polymer that prevents the water from coming in contact with the metal.

**EVERPURE**  
WATER YOU CAN TRUST®

# SPA-400

## product specifications

Commercial grade drinking water system  
for the home spa and bath

SPA-400 System – Part No. EV9270-90  
SPA-400 Cartridge – Part No. EV9270-91

### Features:

- > Finely polishes treated water to premium quality for drinking.
- > Reduces chlorine taste and odor.
- > Reduces dirt, rust, and other particulates such as oxidized iron, manganese, and sulfides.
- > Reduces parasitic protozoan cysts such as Giardia, Entamoeba, and Cryptosporidium.
- > Reduces common earthy, moldy, fishy tastes, and odors.
- > Reduces lead to below the Federal Action Level.

### General Installation/Operation/Maintenance Requirements:

- > It is recommended that before purchasing a water treatment unit, you have your water tested to determine your actual treatment needs.
- > Space required: 5 x 5 x 20 in. (13 x 13 x 51 cm) including 2-1/2 inches of clear space under unit for cartridge change.
- > Install vertically with cartridge hanging down.
- > Use minimum length of tubing possible.
- > Flush new cartridge at full flow for three minutes to purge air.
- > Replace cartridges when capacity is reached, or when flow becomes too slow, but at least annually.
- > Do not use with water that is microbiologically unsafe or of unknown quality without adequate disinfection before or after the system. Systems certified for cyst reduction may be used on disinfected water that may contain filterable cysts.
- > System comes complete with filter cartridge, head, fittings, and connector.

This drinking water system must be maintained according to the manufacturer's instructions, including replacement of filter cartridges. The substances reduced or removed by this system are not necessarily in your water. Read the performance data sheet.

### flow rate

Controlled at 2.2 gal./min. (8.3 L/min.)

### temperature

35-100 °F (2-38 °C) cold water use only

### pressure

10-125 psi. (0.7-8.6 bar), non-shock

### capacity

3,000 gal. (11,356 L)

### everpure warranty

Everpure Drinking Water Systems are warranted to be free of defects for a full twelve (12) months after purchase. A detailed warranty statement is provided with each system.

Everpure, LLC  
1040 Muirfield Drive  
Hanover Park, IL 60133 USA  
Phone: (630) 307-3000  
Fax: (630) 307-3030  
Customer Service: (800) 323-7873  
Technical Service: (800) 942-1153  
[www.everpure.com](http://www.everpure.com)

**EVERPURE**  
WATER YOU CAN TRUST®